

622TC FIXTURE

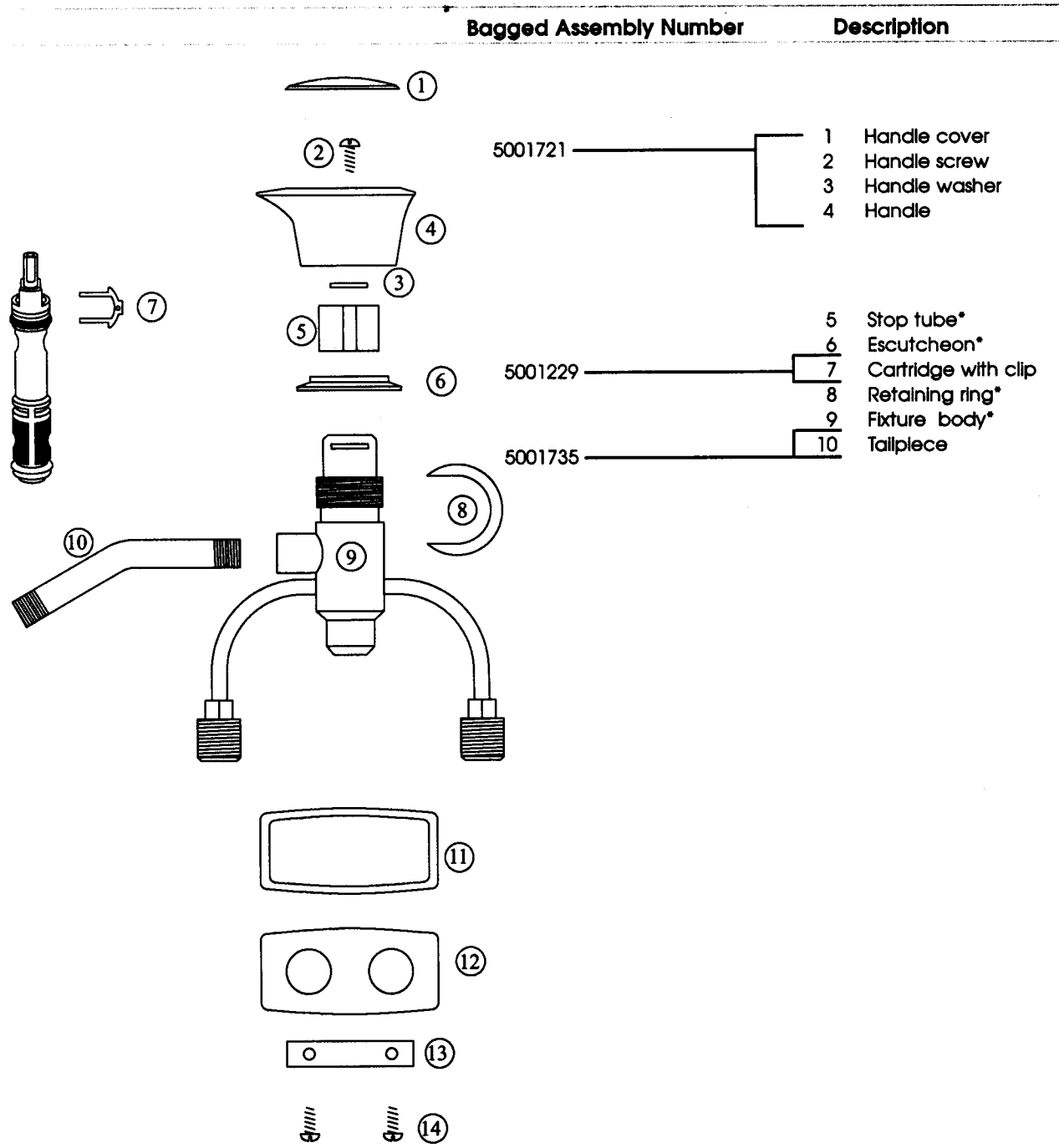

Bagged Assembly Number	Description
------------------------	-------------

5001721	1	Handle cover
	2	Handle screw
	3	Handle washer
	4	Handle

5001229	5	Stop tube*
	6	Escutcheon*
	7	Cartridge with clip
	8	Retaining ring*
5001735	9	Fixture body*
	10	Tailpiece

* Not available as service part.